



ICB group

# ICBos sal offshore

2025 v2

International Consulting Bureau

شركة مدنية - Lebanon – since 2002

International Consulting Bureau sal

Lebanon – since 2009

ICBos sal Offshore

(for architectural & engineering consultancy services)

Lebanon – since 2012

ICB Vision

(for engineering consultancy services)

KSA – since 2014

شركة حدائق الهندسة المحدودة المسؤولة

Syria – since 2019

ICBos Abu Dhabi LLC

(engineering & contracting)

UAE – since 2025



# Table of Contents

<b>About Us</b>	<b>1</b>
<b>Key &amp; Strategic Partners</b>	<b>2</b>
<b>Our Services</b>	<b>4</b>
<b>Our Structure</b>	<b>9</b>
<b>Pre-qualifications &amp; Registrations</b>	<b>11</b>
<b>Major Clients</b>	<b>12</b>
<b>Major Projects &amp; Staff Experience</b>	<b>13</b>
• <b>Military Projects</b>	<b>16</b>
• <b>Master Planning &amp; Infrastructure Projects</b>	<b>18</b>
• <b>International Organization Projects</b>	<b>20</b>
• <b>Standard &amp; Guidelines Projects</b>	<b>21</b>
• <b>Healthcare, Architectural, Structural &amp; MEPF Projects</b>	<b>22</b>
• <b>Technical Due Diligence &amp; Design Audits Projects</b>	<b>30</b>
• <b>Facility Engineering Operation &amp; Maintenance Projects</b>	<b>31</b>
• <b>Other Major Projects</b>	<b>33</b>
<b>Contact Us</b>	<b>36</b>



## About Us

ICBos is a leading multi-disciplinary firm based in Beirut, Lebanon. Originally established in 2002 as a healthcare consulting group, it has since evolved into a full-fledged engineering consultancy, delivering services in the fields of Architecture, Structure, MEPF, Healthcare Planning, Medical Engineering, Facility Management, and Operation & Maintenance.

Our lead engineers bring more than 25 years of experience in Healthcare, Hospitality, Education, Military, Residential and Commercial projects across the Middle East, Africa & Gulf countries. They have also collaborated with leading local and international engineering firms based in the UK, USA, Germany, France, Australia, Saudi Arabia and the UAE.

ICBos delivers smart, high-performance engineering solutions that enhance building operations and systems. We partner with clients who value quality, aiming to build long-term relationships based on trust and results. Our focus is on leading the adoption of advanced technologies and management practices, driving sustainability and excellence in project delivery, and maintaining efficiency and profitability across all services.

## Key Partners



**IMAD ISSA**

Holding a DEA in Biomedical Engineering in 1988 from ENSEEIHT University in Toulouse-France, Imad has been the co-founder of ICB group (ICB, ICBos) and CEO of ICB since 2002. Imad has also managed several projects including major hospitals requiring design, operations & maintenance services in the Middle East and the Gulf countries.



**NAKHLE HUSSEINI**

Holding a MS in Biomedical Engineering in 1988 from Ohio State University in Columbus, USA, Nakhle has been the co-founder of ICB group (ICB, ICBos) and CEO of ICBos since 2002. Nakhle has also managed several projects including major hospitals requiring design, operations & maintenance services in the Middle East and the Gulf countries.



**DANY BITAR**

Holding a BEng. in Electro-Mechanical engineering in 1995 from Concordia University in Montreal, Canada, Dany has managed multi-disciplinary services within contracting and engineering consultancy firms mainly in the Middle East and the Gulf countries. With skills development and leadership in project management, Dany joined ICB group in 2017 as Managing Partner.



## Strategic Partners

### UAE



#### **ABDULRAZAK ALENAZI**

Chairman of the Board / Group CEO  
ARAD International Holding

As ICBos' strategic partner in the UAE, ARAD collaborates with us to expand our regional presence and support operations in engineering design, general contracting, and facility management & maintenance, including hospital and medical equipment maintenance. This partnership facilitates operational growth and market development, primarily across the Gulf countries and Africa.



## Our Services

### Engineering Design Services

Urban Design & Master Planning  
 Architecture, ID & Landscaping  
 Civil & Structure  
 Mechanical & HVAC systems  
 Public Health & Plumbing systems  
 Electrical Power & Lighting systems  
 Extra Low Voltage systems  
 Telecommunication systems  
 Fire Protection systems  
 Roads & Infrastructure networks  
 Transportation services



### Project Management

Project Management  
 Design Management  
 Cost Management

**Facility Engineering Management**  
**Operation & Maintenance services**

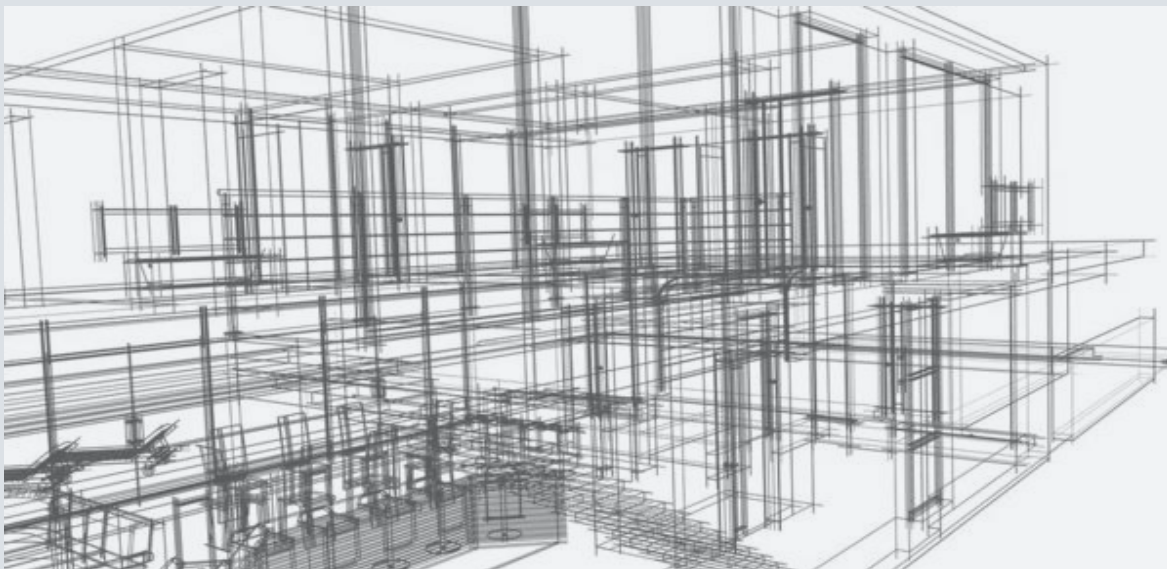

## Our Services (cont'd)

### Specialty Design Services



Interior Design      Geotechnical works

Solar & Hydropower      Power Plants      Energy & Systems Audits





## Our Services (cont'd)

### Construction Services

Construction Management  
 Site Supervision  
 Design Review  
 Shop Drawings  
 Technical Due Diligence  
 Design Audits

### Design Verification Services

3rd Party Design Review  
 Value Engineering

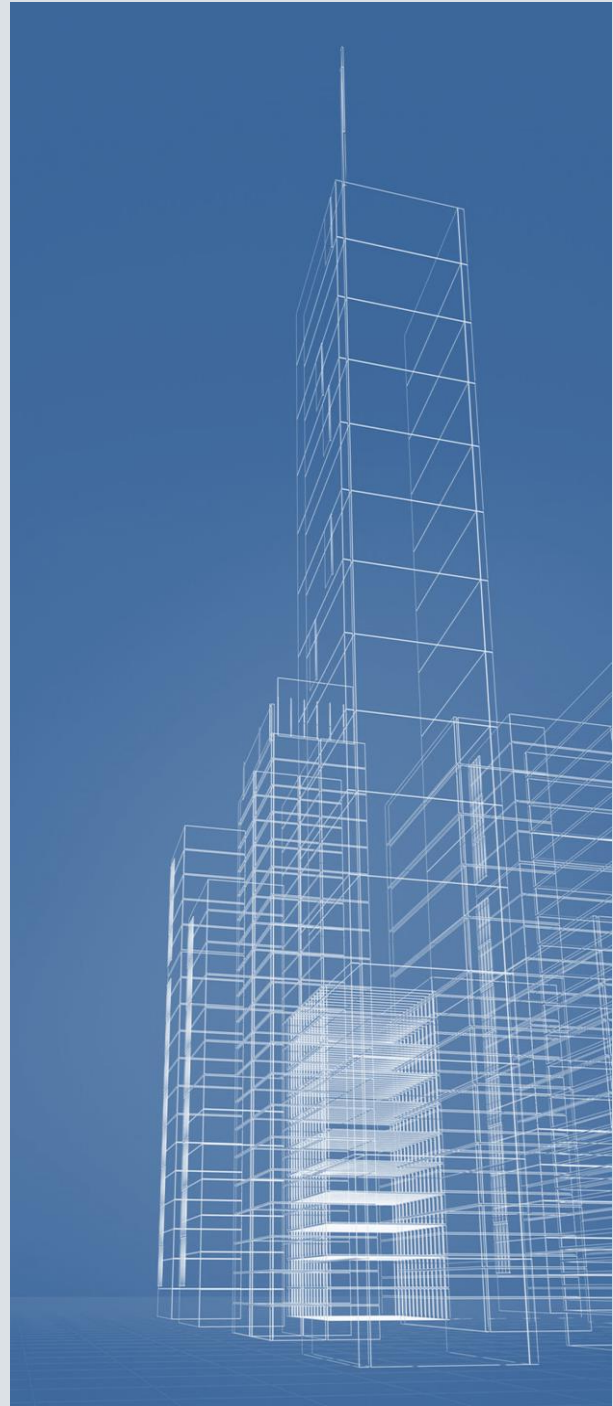
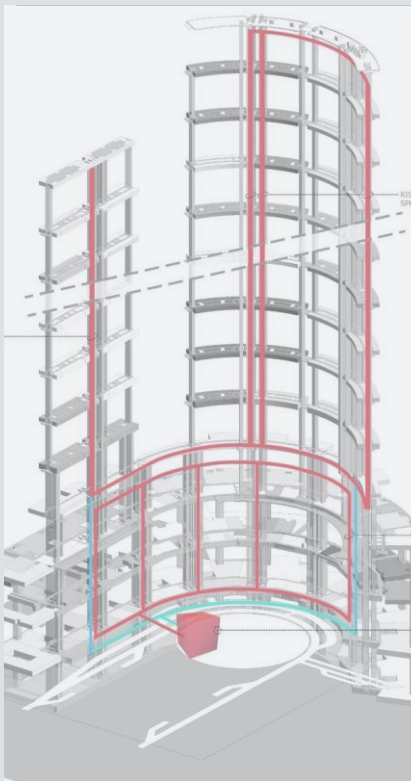

## Our Services (cont'd)

### Hospital Design Services

Project Management | Project Feasibility Study | Project Design Development  
Supervision and Coordination | Facility Engineering Maintenance & Management  
Biomedical Engineering Maintenance & Management

### Hospital Operational Services

Operation and Management Plan | Operational Efficiencies  
Accreditation | Standards & Guidelines



## Our Services (cont'd)

### BIM Services

Full 3D to 7D

Digital construction & Operation

Integrated Project Delivery

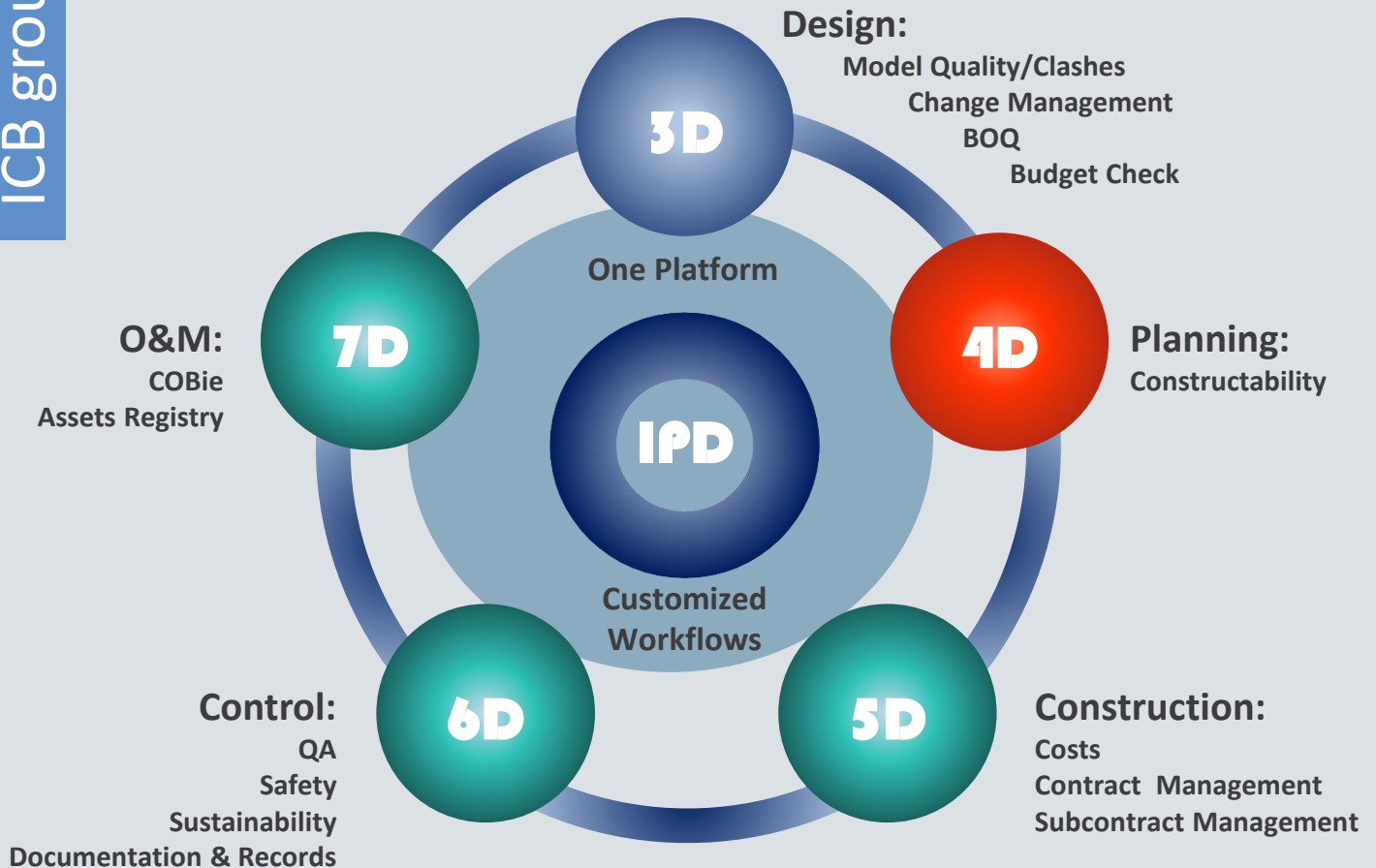

# Our Structure

## Engineering & Construction Services

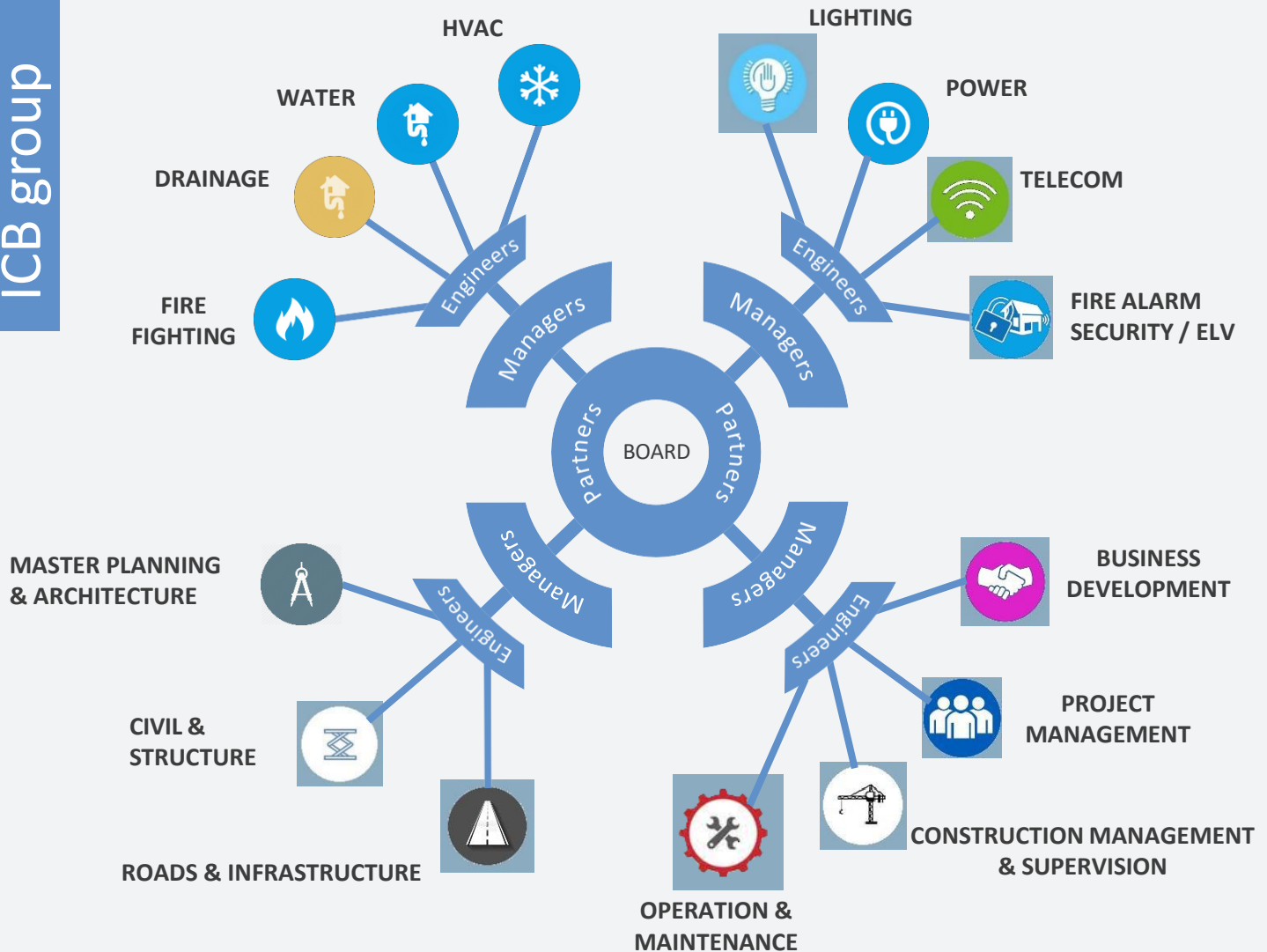

## Our Structure (cont'd)

### Healthcare Services

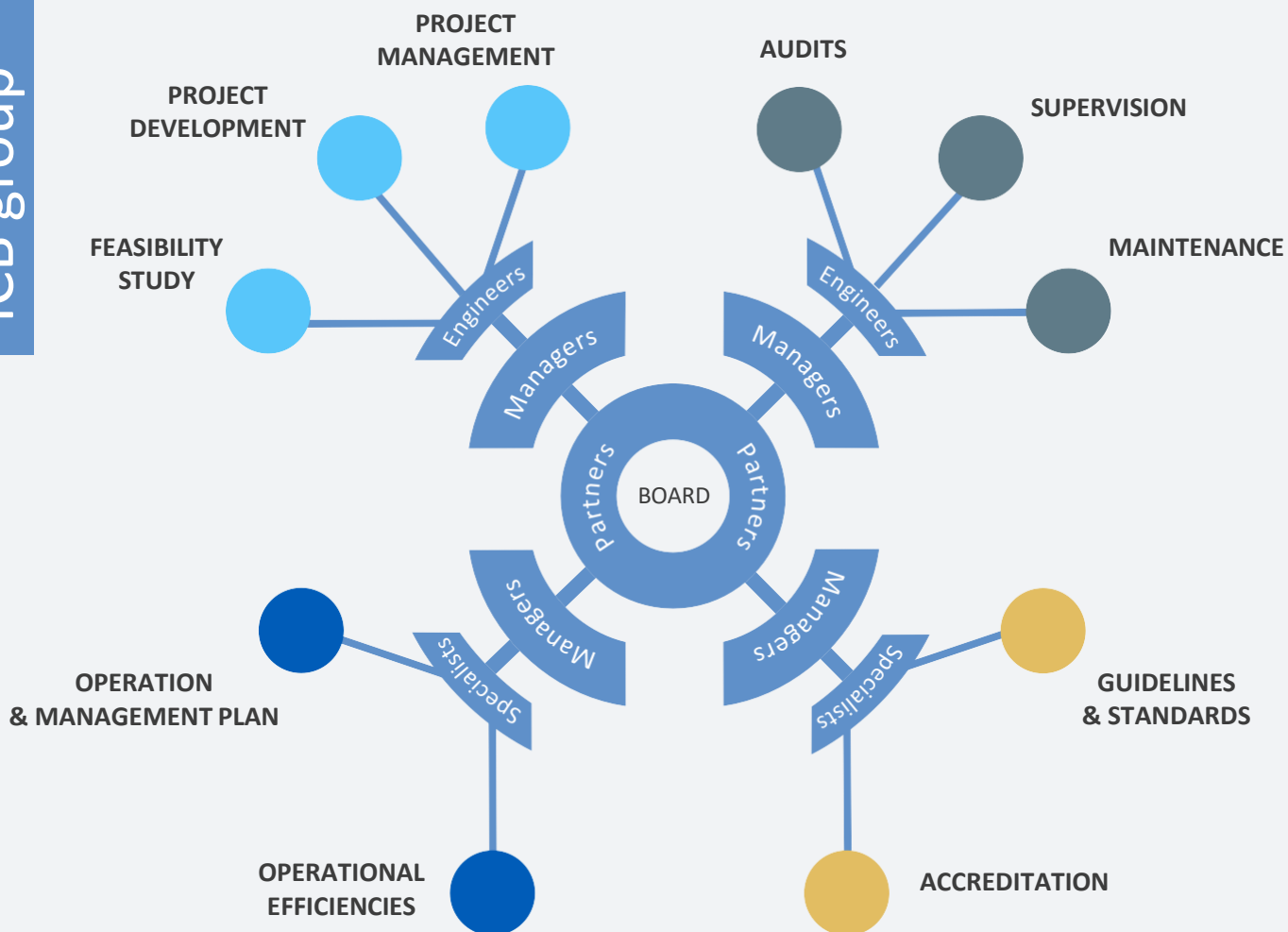



## Pre-qualifications, Registrations & Certificates



ISO 9001:2015



Order of Engineers & Architects - Beirut (Lebanon)



Council for Development and Reconstruction - CDR (Lebanon)



Lebanese Red Cross (Lebanon)



United Nations (UNGM / UNIFIL / UNDP)



Saudi Council of Engineers (KSA)



British Aviation Engineering - BAE Systems (KSA)



National Project Management Organization - MASHROAT (KSA)



The Red Sea Development Company – TRSDC (KSA)



Diyar Al Muharraq - Real Estate Developer/investor (Bahrain)



Kuwait Fund For Arab Economic Development (Kuwait)



Nesma & Partners Consultant Portal



Islamic Development Bank Consultant Portal



NEOM



Association for the Advancement of Blood & Biotherapies  
(American Association of Blood Banks)

## Major Clients

- Ministry of Health (Lebanon)
- Council for Development and Reconstruction - CDR (Lebanon)
- Lebanese Armed Forces (Lebanon)
- Lebanese Red Cross (Lebanon)
- Royal Saudi Air Force / British Aviation Engineer - BAE (KSA)
- Royal Saudi Naval Forces / British Aviation Engineer - BAE (KSA)
- Ministry of Interior (KSA)
- El Seif Engineering & Contracting (KSA)
- Al Mabani General Contractors (KSA & Lebanon)
- Arabian Gulf University Bahrain (Bahrain)
- SaudConsult (KSA)
- Rafik Hariri University Hospital (Lebanon)
- Lebanese University (Lebanon)
- Kuwait Fund For Arab Economic Development (Kuwait)
- Saudi Central Board for Accreditation of Healthcare Institutions (KSA)
- Associated Consulting Engineering - ACE (Lebanon)
- Ministère de la Santé, de la Population et de la Réforme Hospitalière (Algérie)
- Nesma & Partners (KSA)
- Redco International (Qatar)
- Rawabi Specialized Contracting (KSA)

## Major Projects & Staff Experience

### Military Projects

- Royal Saudi Naval Force - Technical Institute of Naval Studies (Dammam, KSA)
- Royal Saudi Air Force - The Hawk T-165 Modernization Facilities (Batch 02) at King Faisal Air Force Base (Tabuk, KSA)
- The Custodian of Two Holy Mosques King Abdullah Bin AbdulAziz (Kap2/C2), in KSA for Developing The Security Headquarters – MOI – Phase 2-C
  - Abha Site: Public Security Training City Class B (91 bldgs.)
  - Abha Site: Special Emergency Forces Camps Class B (62 bldgs.)
  - Abha Site: Medical Center (11 bldgs.)
  - Najran site: Public Security Training City Class C (80 bldgs.)
  - Najran site: Special Emergency Forces Camps Class A (74 bldgs.)
- Royal Saudi Air Force - The Hawk T-165 Facilities (Batch 01) at King Faisal Air Force Base (Tabuk, KSA)
- Dirab Military Airbase - SANG III for the National Guard (Riyadh, KSA)

### Master Planning & Infrastructure Projects

- King Abdullah Healthcare City for the Security Forces - MOI (Riyadh, KSA)
- Jabal Omar Development – Infrastructure Works (Makkah, KSA)
- Dirab Military Airbase - SANG III for the National Guard (Riyadh, KSA)
- Beit Misk – Infrastructure Works (Metn, Lebanon)
- Musaffah Gardens Development - Hotel and Residential Apartments (Abu Dhabi)

### International Organizations Projects

- Lebanese Red Cross BTS, Baabda Central Blood Bank (Lebanon)
- Lebanese Red Cross BTS, Antelias Center (Lebanon)
- Facebook New Offices (Lagos, Nigeria)

### Standards & Guidelines Projects

- Health Facility Guidelines for CBAHI / Ministry of Health (Kingdom of Saudi Arabia)

## Healthcare, Architectural, Structural & MEPF Projects

- Medical Wellness Resort (Amaala, KSA)
- Spine Precast Concrete Facility (NEOM, KSA)
- King Abdullah Medical City - KAMC (Bahrain)
- King Abdullah Healthcare City for the Security Forces (Riyadh, KSA)
- National Health Laboratories (Qatar)
- MEHCC Middle East Hospital & Cardiac Center (Riyadh, KSA)
- Perfect Healthcare Services Hospital (India)
- Bellil Hospital (Algeria)
- Ain-Merane Hospital (Algeria)
- Military Hospital For the Yemeni Armed Forces (Sana'a-Yemen)
- Beni Messous Hospital (Algeria)
- E.P.H. Hassan Badi (Algeria)
- Selim Zmirli Hospital (Algeria)
- International Medical Center (Syria)
- ORDI Primary Diagnostic Center for the Armed Forces. (Sana'a-Yemen)
- Jezzine Governmental Hospital (Lebanon)
- Halba Governmental Hospital, Caza of Akkar (Lebanon)
- Meis-El-Jabal Governmental Hospital (Lebanon)
- Sheif Khalifa Bin Zayed Hospital (Lebanon)
- Zahle Governmental Hospital (Lebanon)
- Saida Governmental Hospital (Lebanon)
- Marjeyoun Governmental Hospital (Lebanon)
- Middle East Institute of Health, Bsalim (Lebanon)
- Prince Abdulaziz Bin Musaad General Hospital (Ar'ar, KSA)
- Nabatieh Governmental Hospital (Lebanon)
- Tannourine Governmental Hospital (Lebanon)
- Rashaya Governmental Hospital (Lebanon)
- Additional Equip. for Rashaya, Tannourine, Sir-el- Denieh & Nabatieh Hospitals (Lebanon)
- Hotel Dieu de France (Lebanon)
- Sibline / Hermel Governmental Hospitals (Lebanon)
- Hrajel Governmental Health Care Center (Lebanon)
- Bechary Governmental Hospital (Lebanon)
- Baalbeck / Dahr El Bashek / Shahar El Gharbi / Tripoli Governmental Hospitals (Lebanon)

## Technical Due Diligence & Design Audits Projects

- Hammoud Hospital University Medical Center - HHUMC (Saida, Lebanon)
- IMC Hospital - Jeddah (Jeddah, KSA)
- Al Mashfa Hospital - Jeddah (Jeddah, KSA)

## Healthcare & Facility Maintenance Projects

- Lebanese University Hadath Campus (Lebanon)
- Red Cross Blood Transfusion Centers (Lebanon)
- Rafik Hariri University Hospital (Lebanon)
- Dahr El Bashek (Lebanon)
- Halba Governmental Hospital (Lebanon)
- Hotel Dieu de France (Lebanon)
- National Institute of Health (Lebanon)



## Solar & Hydropower Energy Projects



- PPA Solar projects (in the process) in Sao Tomé & Brazil



## Other Major Projects



- Mussallah of Jabal Omar Development (Makkah, KSA)
- City Upscale Hotel, Dbayeh Waterfront (Lebanon)
- Malga Residential Complex (Riyadh, KSA)
- Badaro Gardens comprising 3 residential blocks (Beirut, Lebanon)
- Musaffah Gardens Development - Hotel and Residential Apartments (Abu Dhabi, UAE)
- Saraya Tower R16 & Danet Tower Complex (Abu Dhabi, UAE)
- Saraya Hospital (Abu Dhabi, UAE)
- Abu Dhabi Trade Center – Ext. 3 for Hotel / Services Apartments & Offices (UAE)
- Apex Complex comprising Hotel Tower & Office Tower Abu Dhabi (UAE)
- New American School of Doha (Doha, Qatar)
- Clemenceau Medical Center (Beirut, Lebanon)





Project Information		Date	Consulting Services Performed
	<b>Royal Saudi Naval Force, Technical Institute of Naval Studies Facilities Upgrade Works, (Dammam, KSA)</b> <b>Client:</b> Al Mabani General Contractors (KSA) <b>Works' Volume:</b> Confidential <b>Works Value in US\$:</b> Confidential	Aug 2018 till Aug 2020	- Architectural / MEPF/ Structural design review up to Design development (DD) for 9 buildings (confidential) including - Flood Risk Assessment - Fire Life Safety Risk Assessment
	ICBos		
	<b>Royal Saudi Air Force, The Hawk T-165 King Faisal Air Force Base, Tabuk (Batch 02) Kingdom of Saudi Arabia</b> <b>Client:</b> El Seif Engineering & Contracting (Riyadh, KSA) <b>Works' Volume:</b> Confidential <b>Works Value in US\$:</b> Confidential	Jan 2018 till June 2020	- Architectural / MEPF/ Structural design up to Design development (DD) for 6 buildings (confidential) including Apron - Detailed BOQ
	ICBos		
	<b>The Custodian of Two Holy Mosques King Abdullah Bin Abdul Aziz for Developing the Security Headquarters - MOI - Phase 2-C (Kap2/C2) "Abha and Najran Sites" Kingdom of Saudi Arabia</b> <b>Client:</b> ABV Rock Group Ltd. Riyadh, KSA <b>Works' Volume:</b> 318 buildings TBA 477,954m² <b>Works Value in US\$:</b> Confidential	Jan. 2015 Till March 2018	1. Architectural drawings 2. Space allocation & circulation 3. 1/100 loaded drawing & 1/20 elevation/details 4. Electrical, sewage & HVAC drawings 5. BOQ, budget estimation & detailed specifications: electromechanical/medical equipment & furniture 6. Room & door schedule 7. Elaboration of tender / purchase / construction documents
	ICB		
<b>Abha Site Details:</b>	<b>Public Security Training City Class B</b>	Site area: 1,017,362 m2 TBA 116,994 m2 91 buildings	<b>Special Emergency Forces Camps Class B</b> Site area: 582,893 m2 TBA 110,564 m2 62 buildings
	<b>Medical Center</b>	Site area: 9,370 m2 TBA 6,397m2 11 buildings	
<b>Najran Site Details:</b>	<b>Public Security Training City Class C</b>	Site area: 739,888 m2 TBA 88,188 m2 80 buildings	<b>Special Emergency Forces Camps Class A</b> Site area: 656,172 m2 TBA 155,810 m2 74 buildings

Project Information		Date	Consulting Services Performed
	<b>Royal Saudi Air Force, The Hawk T-165 King Faisal Air Force Base, Tabouk (Batch 01) Kingdom of Saudi Arabia</b>	June 2015 till January 2016	MEPF design up to Design development (DD) for 6 buildings (confidential)
	<b>Client:</b> El Seif Engineering & Contracting (Riyadh, KSA) <b>Works' Volume:</b> Confidential <b>Works Value in US\$:</b> Confidential  <i>ICBos</i>		
	<b>Dirab Military Airbase (SANG III), Riyadh, Kingdom of Saudi Arabia</b>	2014 till 2017	Design Engineering and Development for: 1. General Site Works and Battalion area 2. Airfield including design for: - Apron - Landing Lanes - Taxiways - Lighting, etc. 3. New Buildings including Architecture, Structure and MEPF design for:
	<b>Client:</b> NESMA & Partners Contracting <b>Works' Volume:</b> Confidential <b>Works Value in US\$:</b> Confidential  <i>Dany Bitar, Sr. Projects Manager @RELK&amp;P</i>		- Institute HQ - Educational Building - Training Wing HQ - Aviation Maintenance Workshops

	Project Information	Date	Consulting Services Performed
	<p><b>King Abdullah Health Care City</b> Riyadh - Kingdom of Saudi Arabia</p> <p><b>Client:</b> Security Forces KSA. Contractor ABVRock grp.</p> <p><b>Works' Volume:</b> New Health Care City, 1660 Beds Hospital (520,000m<sup>2</sup> BUA), 2.5 million m<sup>2</sup> site area, 35 utility buildings (200,000m<sup>2</sup> BUA).</p> <p>TBA 1,800,000 m<sup>2</sup>.</p> <p><b>Works Value in US\$:</b> 4,500,000,000 (civil &amp; equipment) ICBos &amp; TAHPI</p>	<p>Jan. 2014 till 2017</p>	<p>Design Engineering and Development for:</p> <ul style="list-style-type: none"> <li>- Master Plan</li> <li>- Site Utilities (Solar, MEP plants, etc.)</li> <li>- Site Landscaping</li> <li>- Civil &amp; Roads</li> <li>- Tunnel &amp; Galleries</li> <li>- Infrastructure Networks</li> </ul>
	<p><b>Jabal Omar Development – Infrastructure Works</b> Makkah, Kingdom of Saudi Arabia</p> <p><b>Client:</b> NESMA &amp; Partners Contracting</p> <p><b>Works' Volume:</b> 1.4 km Underground Utility Galleries</p> <p><b>Works Value in US\$:</b> 260,000,000 (construction)</p> <p><i>Dany Bitar, Sr. Projects Manager @RELK&amp;P</i></p>	<p>2011 till 2014</p>	<p>Design Engineering and Development for:</p> <ul style="list-style-type: none"> <li>- Master Plan for roads above galleries</li> <li>- Structure for underground galleries</li> <li>- MEPF for technical rooms, plants, tanks, etc.</li> <li>- Civil Design for 1.4km of Roads, Tunnels and Overpasses.</li> <li>- Infrastructure design for main utility networks including potable &amp; fire water, storm water, sewage and gray water lines, low voltage network, street lighting, low current network including Fire Alarm, Public Address, Access, Control etc.</li> </ul>
	<p><b>Malga Residential Complex</b> Riyadh, Kingdom of Saudi Arabia</p> <p><b>Client:</b> Urjuan Property</p> <p><b>Works' Volume:</b> 18,000 m<sup>2</sup></p> <p><b>Works Value in US\$:</b> 18,500,000 (construction)</p> <p><i>Dany Bitar, Sr. Projects Manager @RELK&amp;P</i></p>	<p>2011 till 2013</p>	<p>Design Engineering and Development for:</p> <ul style="list-style-type: none"> <li>- Master Plan</li> <li>- Civil &amp; Roads</li> <li>- Landscaping</li> <li>- Infrastructure</li> </ul>
	<p><b>Dirab Military Airbase (SANG III),</b> Riyadh, Kingdom of Saudi Arabia</p> <p><b>Client:</b> NESMA &amp; Partners Contracting</p> <p><b>Works' Volume:</b> Confidential</p> <p><b>Works Value in US\$:</b> Confidential</p> <p><i>Dany Bitar, Sr. Projects Manager @RELK&amp;P</i></p>	<p>2014 till 2017</p>	<p>Design Engineering and Development for:</p> <p>General Site Works and Battalion area including</p> <ul style="list-style-type: none"> <li>- Master plan</li> <li>- Infrastructure networks</li> <li>- Landscaping</li> <li>- Civil and road design</li> <li>- Street lighting, etc.</li> </ul>

Project Information		Date	Consulting Services Performed
	<p><b>Beit Misk – Infrastructure Works</b> <b>Metn, Lebanon</b></p> <p><b>Client:</b> Emaar</p> <p><b>Works' Volume:</b> 650,000 m<sup>2</sup> residential development</p> <p><b>Works Value in US\$:</b> 25,000,000 (construction)</p> <p><i>Dany Bitar, Sr. Projects Manager @RELK&amp;P</i></p>	<p>2010 till 2013</p>	<p>Design Engineering and Development for:</p> <ul style="list-style-type: none"><li>- Infrastructure services including Storm Network, Sewage Network, Sewage Treatment Plant, Water Supply, Irrigation, Power (MV, LV), Power Plant, Street Lighting, Telecommunication Network, Fiber Optic Network and Roads.</li></ul>
	<p><b>Musaffah Gardens Development</b> comprising Hotel and Residential Apartments <b>Abu Dhabi, United Arab Emirates</b></p> <p><b>Client:</b> ROYA</p> <p><b>Works' Volume:</b> 30,000 m<sup>2</sup></p> <p><b>Works Value in US\$:</b> 110,000,000 (construction)</p> <p><i>Dany Bitar, Sr. Projects Manager @RELK&amp;P</i></p>	<p>2008 till 2012</p>	<p>Design Engineering and Development for:</p> <ul style="list-style-type: none"><li>- Master Plan</li><li>- Civil &amp; Roads</li><li>- Landscaping</li><li>- Infrastructure</li></ul>

Project Information		Date	Consulting Services Performed
	<p><b>BTS Baabda New Central Blood Bank - Lebanon</b></p> <p><b>Client:</b> Lebanese Red Cross</p> <p><b>Works' Volume:</b> 400 blood units/day</p> <p><b>Works Value in US\$:</b></p> <p>ICB</p>	<p>Oct. 2022 till Present</p>	<ol style="list-style-type: none"><li>1. Design of services covering Medical planning, Architecture, Structure &amp; MEP</li><li>2. Medical equipment</li><li>3. Cost estimate &amp; BOQ</li><li>4. Supervision services</li></ol>
	<p><b>BTS Antelias Centre - Lebanon</b></p> <p><b>Client:</b> Lebanese Red Cross</p> <p><b>Works' Volume:</b> 200 blood units/day</p> <p><b>Works Value in US\$:</b></p> <p>ICB</p>	<p>May 2021 till June 2023</p>	<ol style="list-style-type: none"><li>1. Re-design of services covering Medical planning, Architecture &amp; MEP</li><li>2. Medical equipment</li><li>3. Cost estimate &amp; BOQ</li><li>4. Supervision services</li></ol>
	<p><b>Facebook New Offices (Lagos, Nigeria)</b></p> <p><b>Client:</b> ITB Nigeria</p> <p><b>Works' Volume:</b></p> <p><b>Works Value in US\$:</b></p> <p>ICB</p>	<p>Jan. 2021 Till May 2021</p>	<ol style="list-style-type: none"><li>1. Shop drawings for MEP services</li><li>2. Redesign of MEP services (as needed)</li><li>3. MEP calculations</li><li>4. Review of MEP Material submittals</li></ol>



Project Information

Date

Consulting Services Performed



**Kingdom of Saudi Arabia Health Facility Guidelines**

**Client:** CBAHI / Ministry of Health

**Works' Volume:** confidential





**Works Value in US\$:** confidential

*ICB*

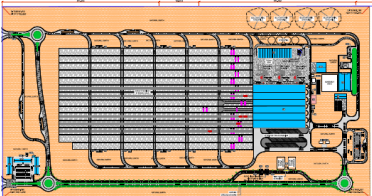
2018  
till  
2019

Consulting services for:  
Preparation of guidelines for planning, briefing,  
design & construction of healthcare facilities

Project Information		Date	Consulting Services Performed
	<p><b>Medical Wellness Resort Amaala (RSG), KSA</b></p> <p><b>Client:</b> Rawabi Specialized Contracting (RSC) In JV with Gama Construction</p> <p><b>Works' Volume:</b> 41,000 m2 BUA, 74 Keys</p> <p><b>Works Value in US\$:</b> N/D</p> <p><i>ICBos, ICB Vision</i></p>	<p>Mar. 2024 till Jan. 2025</p>	<ol style="list-style-type: none"><li>1. Value Engineering Deliverables including VE potentials, options, solutions, comparisons, outputs and variations.</li><li>2. Structural Design revisions.</li><li>3. Structural models review &amp; validation.</li><li>4. IFC Design update for structural works including Revit models, BOQ and Drawings.</li></ol>
	<p><b>Spine Precast Concrete Facility NEOM (Bechtel), KSA</b></p> <p><b>Client:</b> El Seif Engineering Contracting Co. Ltd. In JV with Redco International W.L.L</p> <p><b>Works' Volume:</b> 583,000 m2 BUA including 21 Facility Buildings, Roads and Open Stacking Yard with cranes</p> <p><b>Works Value in US\$:</b> N/D</p> <p><i>ICBos, ICB Vision</i></p>	<p>Feb. 2024 till Present</p>	<ol style="list-style-type: none"><li>1. Design Verification services for Architecture (master plan &amp; buildings), Structure (buildings, equipment/crane foundations, concrete batching plant foundations, perimeter fence, underground tanks), MEP design (buildings) and Infrastructure networks (foul water, potable water, irrigation, ELV, Fire Alarm, HVAC, firefighting, fire alarm, public address, Communication &amp; Security, External Power, External Lighting, CCTV, Irrigation network and External Steam piping)</li><li>2. Design Services for Fire Life Safety design for entire facility, Traffic Study (including pavement design, turning radius / swept path analysis, traffic signage design), Wayfinding signage design and Storm water network design.</li></ol>

	Project Information	Date	Consulting Services Performed
	<p><b>King Abdullah Medical City - KAMC Bahrain</b></p> <p><b>Client:</b> Arabian Gulf University</p> <p><b>Works' Volume:</b> New Medical City, complete design of 250 beds for first phase</p> <p><b>Works Value in US\$:</b> 260,000,000 (civil &amp; equipment)</p> <p><i>ICBos, TAHPI &amp; Saudi Consult</i></p>	<p>Feb. 2015 till May 2021</p>	<ol style="list-style-type: none"> <li>1. Medical equipment planning</li> <li>2. Electromechanical requirements</li> <li>3. Medical equipment drawings</li> <li>4. Schematic design up to Construction</li> <li>5. Medical equipment procurement services</li> <li>6. Supervision services</li> </ol>
	<p><b>King Abdullah Health Care City Riyadh - Kingdom of Saudi Arabia</b></p> <p><b>Client:</b> Security Forces KSA. Contractor ABV Rock grp.</p> <p><b>Works' Volume:</b> New Health Care City, 1660 Beds Hospital (520,000m<sup>2</sup> BUA), 2.5 million m<sup>2</sup> site area, 35 utility buildings (200,000m<sup>2</sup> BUA). TBA 1,800,000 m<sup>2</sup>.</p> <p><b>Works Value in US\$:</b> 4.5 billion (civil &amp; equipment)</p> <p><i>ICBos &amp; TAHPI</i></p>	<p>Jan. 2014 till 2017</p>	<ol style="list-style-type: none"> <li>1. Design of services for all phases (Master plan, SD, DD, CD) covering architecture, MEP, structure civil including soft and hard landscaping &amp; all engineering subspecialties</li> <li>2. Medical equipments planning</li> <li>3. Electromechanical requirements</li> <li>4. Medical equipments drawings</li> <li>5. Schematic design up to construction documents for interior architectural layout and interior design for administration building 9,000m<sup>2</sup> and data center 12,000m<sup>2</sup></li> </ol>
	<p><b>National Health Laboratories Qatar</b></p> <p><b>Client:</b> Focus Design Partners (FDP)</p> <p><b>Works' Volume:</b> Design of lab equipment for national health laboratories (50,000m<sup>2</sup>)</p> <p><b>Works Value in US\$:</b> 40,000,000</p> <p><i>ICBos</i></p>	<p>2015 Till 2016</p>	<ol style="list-style-type: none"> <li>1. MEP</li> <li>2. Space allocation</li> <li>3. Medical equipment specifications</li> </ol>
	<p><b>Middle East Hospital &amp; Cardiac Center, MEHCC Riyadh - Kingdom of Saudi Arabia</b></p> <p><b>Client:</b> Philips Health Care Saudi Arabia Limited</p> <p><b>Works' Volume:</b> 200 beds</p> <p><b>Works Value in US\$:</b> 200,000,000</p> <p><i>ICBos</i></p>	<p>Sept. 2015 till Dec. 2015</p>	<ol style="list-style-type: none"> <li>1. Provide guidance, local codes and regulations</li> <li>2. Structural &amp; MEPF</li> <li>3. Engineering medical equipment plan</li> </ol>

	Project Information	Date	Consulting Services Performed
	<b>Perfect Healthcare Services Hospital, Calicut India</b> <b>Client:</b> KEF Dubai <b>Works' Volume:</b> New Hospital, complete design of 250 beds <b>Works Value in US\$:</b> 70,000,000 (civil & equipment) <i>ICB &amp; TAHPI</i>	Aug.2013 till May 2014	1. Medical equipments planning 2. Medical equipments review and detailed specifications 3. Electromechanical requirements 4. Medical equipments drawings
	<b>Bellil Hospital Algeria</b> <b>Client:</b> Direction de la Santé et de la Population de Laghouat, Algérie <b>Works' Volume:</b> New hospital, complete design of 60 beds with supervision <b>Works Value in US\$:</b> 13,000,000 (civil) <i>ICBss &amp; ICB</i>	Nov. 2010 till 2013	1. Architectural drawings 2. Space allocation & circulation 3. 1/100 loaded drawing & 1/20 elevation/details 4. Electrical, sewage & HVAC drawings 5. Medical gases drawings, loaded drawings: electromechanical/medical & furniture 6. BOQ, budget estimation & detailed specifications: electromechanical / medical equipment & furniture 7. Room & door schedule 8. Elaboration of tender/purchase/construction documents. 9. Supervision over construction
	<b>Ain-Merane Hospital Algeria</b> <b>Client:</b> Direction de la Santé et de la Population de Chief, Algérie <b>Works' Volume:</b> New hospital, complete design of 60 beds with supervision <b>Works Value in US\$:</b> 14,500,000 (civil) <i>ICBss &amp; ICB</i>	Jan. 2009 Till Dec. 2010	<i>Same as above</i>
	<b>Military Hospital for the Yemeni Armed Forces Sana'a - Yemen</b> <b>Client:</b> TEAM International, Beirut (Yemeni Governmental Fund) <b>Works' Volume:</b> Rehabilitation of 300 beds <b>Works Value in US\$:</b> 15,000,000 (equipment) <i>ICB</i>	Jan.2004 till July 2004	Consultancy services for revision of concept of the hospital with complete redesign of the specialized services. Creation of tender documents, bill of quantities, detailed drawings with equipment layout and loaded drawing with electromechanical requirement. Specifications and budget estimation.

## Project Information

## Date

## Consulting Services Performed

**Beni Messous Hospital  
Algeria**

**Client:** Ministère de la Santé, de la Population et de la Reforme Hospitalière, Algérie

**Works' Volume:** Rehabilitation of General Surgery Dept, 3 operating rooms, 4 beds Intensive Care, 1 CSSD and 35 beds for hospitalization

**Works Value in US\$:** 2,765,145  
*ICBss & ICB*

Dec. 2009  
Till  
June 2010

1. Architectural drawings
2. Space allocation & circulation
3. 1/100 loaded drawing & 1/20 elevation and details
4. Electrical, sewage & HVAC drawings
5. Medical gases drawings, loaded drawings: electromechanical/medical & furniture
6. BOQ, budget estimation & detailed specifications: electromechanical/medical equipment & furniture
7. Room & door schedule
8. Elaboration of tender/purchase/construction documents
9. Supervision over construction

**E.P.H. Hassan  
Badi Algeria**

**Client:** Ministère de la Santé, de la Population et de la Reforme Hospitalière, Algérie

**Works' Volume:** Rehabilitation of OB/GYN Surgery Dpt, 3 operating rooms and 4 beds Intensive Care

**Works Value in US\$:** 2,000,000 (civil)

*ICBss & ICB*

April 2009  
till  
Oct. 2009

*Same as above*

**Selim Zmirli  
Hospital Algeria**

**Client:** Ministère de la Santé, de la Population et de la Reforme Hospitalière, Algérie

**Works' Volume:** New design of an extension for an operation complex (3000m<sup>2</sup> of 12 operating rooms, 18 recovery beds and CSSD

**Works Value in US\$:** 2,816,253 (civil)

*ICBss & ICB*

April 2008  
till  
Dec. 2008

*Same as above*

**International Medical Center  
Syria**

**Client:** Associated Consulting Engineers (ACE)

**Works' Volume:** New hospital, complete design of 150 beds

**Works Value in US\$:** 120,000,000 (civil) & 30,000,000 (equipment)

*ICB*

March 2007  
till  
Jan. 2008

1. Review of design
2. Space allocation
3. Circulation
4. 1/100 loaded drawing
5. 1/20 elevation and details
6. Medical equipment: BOQ detailed specifications and Tender Documents



### Project Information

### Date

### Consulting Services Performed



**ORDI Primary Diagnostic Center for the Armed Forces**

**Sana'a - Yemen**

**Client:** TEAM International, Beirut (Yemeni Governmental Fund)

**Works' Volume:** Rehabilitation of Diagnostic Center

**Works Value in US\$:** 5,000,000 (equipment)

*ICB*

Jan. 2004  
till  
July 2004

Consultancy services for revision of concept of the hospital with complete redesign.  
Creation of tender documents, bill of quantities, detailed drawings with equipment layout and loaded drawing with electromechanical requirement. Specifications and budget estimation.



**Jezzine Governmental Hospital & Rmeich Primary Healthcare Center, Lebanon**

**Client:** Council for Development & Reconstruction CDR Beirut, Islamic Development Bank (IDB Fund)

**Works' Volume:** 80 Beds

**Works Value in US\$:** 3,000,000 (equipment)

*Abdelwahed Chehab Consulting Engineering Office  
Joint-Venture ICB*

Dec. 2009  
till  
2011

Consultancy services for the coordination and Supervision of installation of medical equipment and furniture



**Halba Governmental Hospital, Akkar Lebanon**

**Client:** Council for Development & Reconstruction CDR Beirut (OPEC Fund)

**Works' Volume:** 75 Beds

**Works Value in US\$:** 2,459,000 (equipment)

*Abdelwahed Chehab Consulting Engineering Office  
Joint-Venture ICB*

Dec. 2002  
till  
Feb. 2004

Consultancy services for the coordination and supervision of installation of medical equipment and furniture



**Meis el Jabal Governmental Hospital Lebanon**

**Client:** Kuwait Fund for Arab Economic Development (KFAED)

**Works' Volume:** 70 beds



**Works Value in US\$:** 1,500,000 (civil) & 3,500,000 (equipment)

*Abdelwahed Chehab Consulting Engineering Office  
Joint-Venture ICB*

July 2001  
Till  
May  
2004

Design, supervision, management, coordination and commissioning

	Project Information	Date	Consulting Services Performed
	<p><b>Sheikh Khalifa Bin Zayed Hospital</b> <b>Lebanon</b></p> <p><b>Client:</b> MA Consulting Group (United Arab Emirates Funds)</p> <p><b>Works' Volume:</b> New Hospital, complete design of 40 beds</p> <p><b>Works Value in US\$:</b> 11,000,000 (civil) &amp; 5,000,000 (equipment)</p> <p><i>ICB</i></p>	<p>Dec.2006 till March 2007</p>	<ol style="list-style-type: none"> <li>1. Review of design</li> <li>2. Space allocation</li> <li>3. Circulation</li> <li>4. 1/100 loaded drawing</li> <li>5. 1/20 elevation and details</li> <li>6. Medical equipment: BOQ detailed specifications and Tender documents</li> </ol>
	<p><b>Zahle Governmental Hospital</b> <b>Lebanon</b></p> <p><b>Client:</b> Council for Development &amp; Reconstruction CDR Beirut, Islamic Development Bank (IDB Fund)</p> <p><b>Works' Volume:</b> 220 beds</p> <p><b>Works Value in US\$:</b> 5,370,000 (equipment)</p> <p><i>Abdelwahed Chehab Consulting Engineering Office Joint-Venture ICB</i></p>	<p>Jan.2006 till Jan. 2007</p>	<p>Consultancy services for the coordination and supervision of installation of medical equipment and furniture</p>
	<p><b>Saida Governmental Hospital</b> <b>Lebanon</b></p> <p><b>Client:</b> Council for Development &amp; Reconstruction CDR Beirut, Islamic Development Bank (IDB Fund)</p> <p><b>Works' Volume:</b> 130 beds</p> <p><b>Works Value in US\$:</b> 5,290,000 (equipment)</p> <p><i>Abdelwahed Chehab Consulting Engineering Office Joint-Venture ICB</i></p>	<p>Jan. 2006 till Nov. 2006</p>	<p>Consultancy services for the coordination and supervision of installation of medical equipment and furniture</p>
	<p><b>Marjeyoun Governmental Hospital</b> <b>Lebanon</b></p> <p><b>Client:</b> Council for Development &amp; Reconstruction CDR Beirut, Islamic Development Bank (IDB Fund)</p> <p><b>Works' Volume:</b> 60 beds</p> <p><b>Works Value in US\$:</b> 1,600,000 (equipment)</p> <p><i>Abdelwahed Chehab Consulting Engineering Office Joint-Venture ICB</i></p>	<p>May 2005 till June 2006</p>	<p>Consultancy services for the coordination and supervision of installation of medical equipment and furniture</p>

	Project Information	Date	Consulting Services Performed
	<b>National Institute of Health, Bsalm Lebanon</b> <b>Client:</b> National Institute of Health, Bsalm <b>Works' Volume:</b> 160 Beds <b>Works Value in US\$:</b> 35,000,000 (civil) & 3,500,000 (equipment) <i>ICB</i>	July 2001 till Dec. 2003	Specification review, project manager for coordination, supervision and commissioning
	<b>Prince Abdulaziz Bin Musaad General Hospital, Ar'ar - Kingdom of Saudi Arabia</b> <b>Client:</b> Al Otaishan Group - AREEL <b>Works' Volume:</b> 100 beds <b>Works Value in US\$:</b> 20,000,000 (civil) & 5,000,000 (equipment) <i>ICB</i>	July 2002 till Sep. 2002	Review of specifications of medical equipment
	<b>Nabatieh Governmental Hospital Lebanon</b> <b>Client:</b> Associated Consulting Engineering, Kuwait Fund for Arab Economic Development (KFAED Fund) <b>Works' Volume:</b> 70 Beds <b>Works Value in US\$:</b> 2,642,178 (equipment) <i>ICB</i>	April 1997 till Sep. 1997	Coordination, supervision and commissioning
	<b>Tannourine Governmental Hospital Lebanon</b> <b>Client:</b> Associated Consulting Engineering, Kuwait Fund for Arab Economic Development (KFAED Fund) <b>Works' Volume:</b> 40 beds <b>Works Value in US\$:</b> 1,727,719 (equipment) <i>ICB</i>	April 1997 till Sep. 1997	Coordination, supervision and commissioning

## Project Information

## Date

## Consulting Services Performed

**Rashaya Governmental Hospital Lebanon**

**Client:** Associated Consulting Engineering, Kuwait Fund for Arab Economic Development (KFAED Fund)

**Works' Volume:** 40 Beds

**Works Value in US\$:** 1,727,719 (equipment)

ICB

April 1997  
till  
Sep. 1997

Coordination, supervision and commissioning

**Additional Equipment for Rashaya, Tannourine, Sir el Denieh & Nabatieh Hospitals Lebanon**

**Client:** Associated Consulting Engineering, Kuwait Fund for Arab Economic Development (KFAED Fund)

**Works' Volume:**

**Works Value in US\$:** 553,445 (equipment)

ICB

Coordination, supervision and commissioning

**Hotel Dieu de France Lebanon**

**Client:** Hotel Dieu de France

**Works' Volume:** 450 beds

**Works Value in US\$:**

ICB

March 2001  
till  
April 2010

Responsible for the elaboration of financial studies for the hospital such as cost of operation, yield Management, feasibility. Work closely with the board of directors for the elaboration of financial policies, and financial analysis.

Hospital planning Design Review and Redesigning of the Hospital Functional Program o Review and Approval of:

- Space Allocation, Department Distribution
- Interdepartmental relation and flow
- Functional Analysis

- Architecture Single line
- Finishing Material and Room



Schedule o Preparation of:

- 1:100 Loaded drawings
- 1:20 Detailed drawings
- Counters and casework detailed drawings
- Electro-mechanical requirements

- BOQ, Room Schedule and Budget Estimation
- Specifications of Medical Equip.& Furnit.
- Tender / Purchase document

	Project Information	Date	Consulting Services Performed
	<b>Hammoud Hospital University Medical Center (HHUMC)</b> <b>Saida, Lebanon</b>	April 2021 till May 2021	Audit, survey and observation of medical planning & medical equipment/biomedical systems, energy consumption, physical conditions, maintainability, code compliance, authorities compliance, life safety, recommendations, and cost estimates of repairs. Medical planning/Medical Equipment design
	<b>Client:</b> Confidential  <b>Works' Volume:</b> 325 beds  <i>ICB</i>		
	<b>IMC Hospital- Jeddah,</b> <b>Kingdom of Saudi Arabia</b>	May 2017 till Oct 2017	Audit, survey of current hospital facilities. MEPF Study and assessment of energy efficiency, noise control related to mechanical equipment, generators and sound attenuations. Study and assessment of safety and life related to fire alarms & firefighting systems in compliance with civil defence and NFPA, security. MEPF Design Development.
	<b>Client:</b> IMC Hospital  <b>Works' Volume:</b> 300 Beds  <i>ICBos</i>		
	<b>Al Mashfa Hospital-Jeddah,</b> <b>Kingdom of Saudi Arabia</b>	Feb 2017 till April 2017	Audit, survey and observation of: structural, MEPF & biomedical systems, energy consumption, physical conditions, maintainability, code compliance, authorities compliance, life safety. Recommendations, and cost estimates of repairs MEPF Design Development
	<b>Client:</b> Amanat Holdings  <b>Works' Volume:</b> total BUA of ~ 30,545 m2 (80 beds)  <i>ICBos</i>		



Project Information		Date	Consulting Services Performed
	<p><b>Rafik Hariri University City and its affiliated facilities - Hadath Campus Lebanon</b></p> <p><b>Client:</b> Lebanese University</p> <p><b>Works' Volume:</b> 705,000m<sup>2</sup> (land) 370,000m<sup>2</sup> (BUA)</p> <p><b>Works Value in US\$:</b></p> <p>ICB</p>	<p>Aug. 2023 till Nov. 2024</p>	<p>Management, operation and maintenance of all facilities and electromechanical systems in the 11 faculties, sports stadium &amp; dormitories of the university campus including corrective/preventive maintenance, monitoring / efficiency measures, spare parts and updating new equipment &amp; systems for Civil, HVAC, Plumbing, Electrical, Generators, Fire, BMS, Elevators, etc.</p>
	<p><b>Blood Transfusion Services - Lebanon</b></p> <p><b>Client:</b> Red Cross</p> <p><b>Works' Volume:</b> 13 centers</p> <p><b>Works Value in US\$:</b> N/D</p> <p>ICB</p>	<p>July 2020 till Present</p>	<p>Blood transfusion laboratory equipment supervision, maintenance and support for 13 centers across Lebanon.</p>
	<p><b>Rafik Hariri University Hospital (Beirut Governmental University Hospital) Lebanon</b></p> <p><b>Client:</b> Rafik Hariri University Hospital</p> <p><b>Works' Volume:</b> 550 beds</p> <p><b>Works Value in US\$:</b> 5,801,000</p> <p>ICB</p>	<p>Sept. 2016 till Aug. 2023</p>	<p>Supervision and Corrective/preventive maintenance of all biomedical and electromechanical equipment in the hospital including energy consumption monitoring/efficiency measures, spare parts and updating new equipment.</p>

### Project Information

### Date

### Consulting Services Performed



#### **Dahr el Bashek Hospital Lebanon**

**Client:** Dahr el Bashek Governmental Hospital (WB Fund)

**Works' Volume:** 120 beds

**Works Value in US\$:**

ICB

July 2004  
till  
July 2007

Corrective and preventive maintenance of all biomedical and electromechanical equipment in the hospital including spare parts and updating new equipment



#### **Halba Governmental Hospital, Akkar Lebanon**

**Client:** Halba Governmental Hospital

**Works' Volume:** 75 beds

**Works Value in US\$:** 180,000

ICB

Oct. 2004  
till  
Oct. 2006

Supervision and Corrective/preventive maintenance of all biomedical and electromechanical equipment in the hospital including spare parts and updating new equipment



#### **Hotel Dieu de France Lebanon**

**Client:** Hotel Dieu de France

**Works' Volume:** 450 beds

**Works Value in US\$:**

ICB

May 1991  
till  
May 2009

Corrective and preventive maintenance of all biomedical equipment in the hospital



#### **National Institute of Health, Bsalim Lebanon**

**Client:** National Institute of Health (WB Fund)





**Works' Volume:** 160 beds

**Works Value in US\$:**

ICB

Oct. 2003  
till  
Oct. 2004

Corrective and preventive maintenance of all biomedical and electromechanical equipment in the hospital including spare parts and updating new equipment

	Project Information	Date	Consulting Services Performed
	<b>Mussallah of Jabal Omar Development</b> <b>Makkah, Kingdom of Saudi Arabia</b> <b>Client:</b> JODC <b>Works' Volume:</b> 150,000 m <sup>2</sup> for 70,000 pilgrims <b>Works Value in US\$:</b> 160,000,000 (construction)	2012 till 2014	Design Engineering and Development for: - Architecture - Structure - MEPF
	<i>Dany Bitar, Sr. Projects Manager @RELK&amp;P</i>		
	<b>City Upscale Hotel</b> <b>Dbayeh Waterfront, Lebanon</b> <b>Client:</b> Majed Al Futtaim <b>Works' Volume:</b> 17,500 m <sup>2</sup> <b>Works Value in US\$:</b> 45,000,000 (construction)	2012 till 2013	Design Engineering and Development for: - Structure - MEPF
	<i>Dany Bitar, Sr. Projects Manager @RELK&amp;P</i>		
	<b>Malga Residential Complex</b> <b>Riyadh, Kingdom of Saudi Arabia</b> <b>Client:</b> Urjuan Property <b>Works' Volume:</b> 18,000 m <sup>2</sup> <b>Works Value in US\$:</b> 18,500,000 (construction)	2011 till 2013	Design Engineering and Development for: Buildings including: - Architecture - Structure - MEPF
	<i>Dany Bitar, Sr. Projects Manager @RELK&amp;P</i>		
	<b>Badaro Gardens</b> comprising 3 residential blocks <b>Beirut, Lebanon</b> <b>Client:</b> AAA Architects <b>Works' Volume:</b> one 17 stories and two 7 stories blocks <b>Works Value in US\$:</b> 16,000,000 (construction for each)	2008 till 2014	Design Engineering and Development for: - Structure - MEPF
	<i>Dany Bitar, Sr. Projects Manager @RELK&amp;P</i>		

	Project Information	Date	Consulting Services Performed
	<p><b>Musaffah Gardens Development</b> comprising Hotel and Residential Apartments  <b>Abu Dhabi, United Arab Emirates</b></p> <p><b>Client:</b> ROYA</p> <p><b>Works' Volume:</b> 30,000 m<sup>2</sup></p> <p><b>Works Value in US\$:</b> 110,000,000 (construction)</p> <p><i>Dany Bitar, Sr. Projects Manager @RELK&amp;P</i></p>	<p>2008 till 2012</p>	<p>Design Engineering and Development for:</p> <ul style="list-style-type: none"> <li>- Architecture</li> <li>- Structure</li> <li>- MEPF</li> <li>- Site utilities/ infrastructure networks</li> </ul>
	<p><b>Saraya Tower R16 &amp; Danet Tower Complex</b>  <b>Abu Dhabi, United Arab Emirates</b></p> <p><b>Client:</b> R&amp;K Architects</p> <p><b>Works' Volume:</b> 33 residential floors each tower</p> <p><b>Works Value in US\$:</b> 54,000,000 (construction for each)</p> <p><i>Dany Bitar, Sr. Projects Manager @RELK&amp;P</i></p>	<p>2008 till 2011</p>	<p>Design Engineering and Development for:</p> <ul style="list-style-type: none"> <li>- Structure</li> <li>- MEPF</li> </ul>
	<p><b>Saraya Hospital</b>  <b>Abu Dhabi, United Arab Emirates</b></p> <p><b>Client:</b> Sorouh</p> <p><b>Works' Volume:</b> 400 beds</p> <p><b>Works Value in US\$:</b> 200,000,000 (construction)</p> <p><i>Dany Bitar, Sr. Projects Manager @RELK&amp;P</i></p>	<p>2008 till 2010</p>	<p>Design Engineering and Development for:</p> <ul style="list-style-type: none"> <li>- Architecture</li> <li>- Structure</li> <li>- MEPF</li> </ul>
	<p><b>Abu Dhabi Trade Center – Extension 3</b> comprising Hotel / Services Apartments &amp; Offices  <b>Abu Dhabi, United Arab Emirates</b></p> <p><b>Client:</b> MACE</p> <p><b>Works' Volume:</b> 88,000 m<sup>2</sup></p> <p><b>Works Value in US\$:</b> 400,000,000 (construction)</p> <p><i>Dany Bitar, Sr. Projects Manager @RELK&amp;P</i></p>	<p>2008 till 2009</p>	<p>Design Engineering and Development for:</p> <ul style="list-style-type: none"> <li>- Structure</li> <li>- MEPF</li> </ul>



Project Information	Date	Consulting Services Performed
<b>Apex Complex</b> comprising Hotel Tower & Office Tower <b>Abu Dhabi, United Arab Emirates</b> <b>Client:</b> CAP <b>Works' Volume:</b> 80,000 m <sup>2</sup> <b>Works Value in US\$:</b> 100,000,000 (construction)  <i>Dany Bitar, Sr. Projects Manager @RELK&amp;P</i>	2008	Design Engineering and Development for: - Structure - MEPF



<b>New American School of Doha</b> <b>Doha, Qatar</b> <b>Client:</b> ACS / Hill International <b>Works' Volume:</b> 30,000 m <sup>2</sup> <b>Works Value in US\$:</b> confidential  <i>Dany Bitar, Project Manager MEP @Al Sraiya Contracting</i>	2006 till 2008	Construction Engineering & Execution Works for: - Architecture - Civil & Structure - MEPF - Chiller Plant - Sports fields
---	----------------------	--



<b>Clemenceau Medical Center</b> <b>Beirut, Lebanon</b> <b>Client:</b> CMC <b>Works' Volume:</b> 150 beds <b>Works Value in US\$:</b> 150,000,000  <i>Dany Bitar, Project Manager MEP @Equip Engineering &amp; Contracting</i>	2004 till 2006	Construction Engineering & Execution Works for: - Architecture - Structure - MEPF
--	----------------------	--



## Contact Us

**Contact Address (Main Office):**

Aresco Tower, 4th floor  
St. Justinian Street, Clemenceau  
Beirut, Lebanon.

Tel	+961 1 347 597
Fax/Tel	+961 1 736 233
Email	contact@icb-hq.com
Web	www.icb-hq.com

**Imad Issa**

Email:	drimadissa@gmail.com
Mobile:	+961 3 957 701

**Nakhle Hussein**

Email:	nakhle.husseini@gmail.com
Mobile:	+961 3 302 619

**Dany Bitar**

Email:	danykbitar@gmail.com
Mobile 1:	+961 3 300 171
Mobile 2:	+966 53 105 7866